

BATTLE McCARTHY®

Consulting Engineers & Landscape Architects

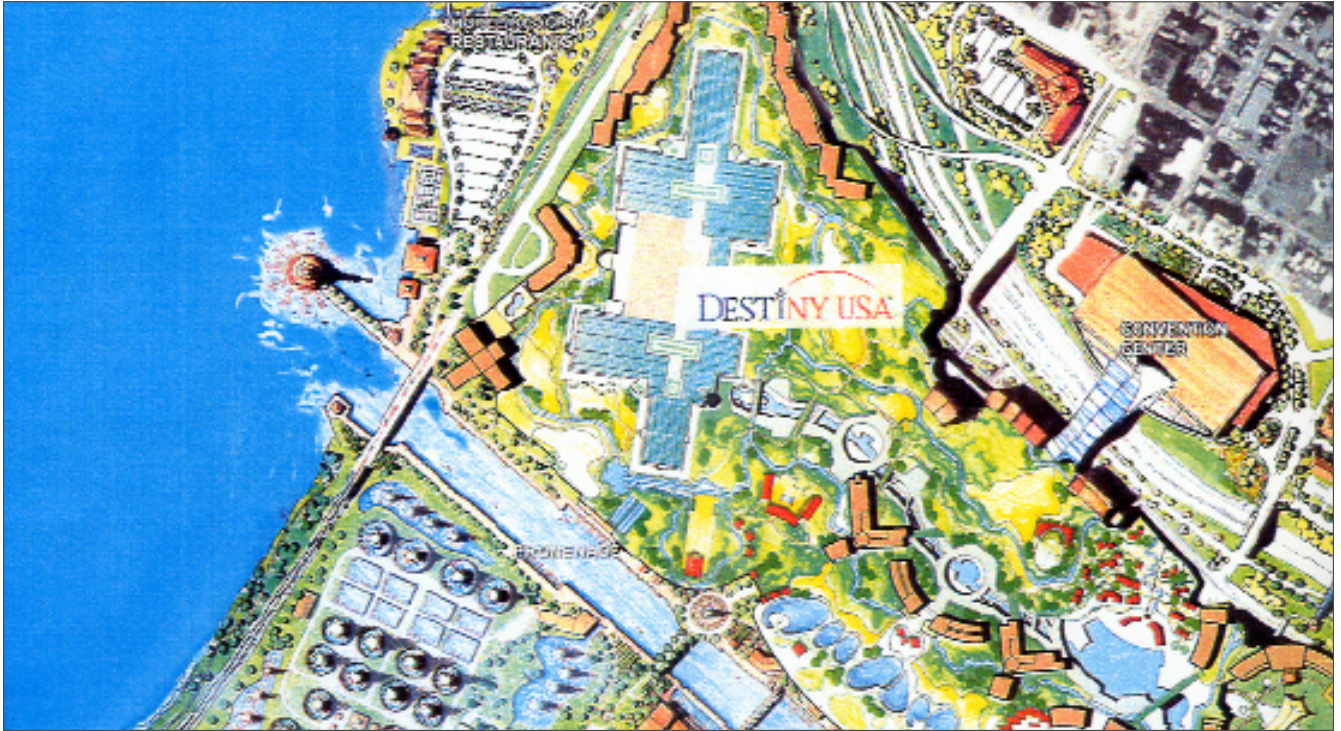

PROJECT:

DestiNY USA, Syracuse

CLIENT:

Pyramid

ARCHITECTS:

Foster & Partners and Fieldman Architects

BM SERVICES:

Building Services (MEP) Engineering,
Structural Engineering, Sustainability Consultancy
& Landscape Architecture

VALUE:

Classified

DESIGN BRIEF

To develop a sustainable masterplan with Foster and Partners for a multi billion-dollar project in Syracuse, upstate New York. The project includes the largest retail mall in the world with 44 million visitors expected per year situated below a covered 100 acre park, incorporating an aqua park and various leisure facilities. The development includes hotels collectively providing 25,000 rooms, a convention center, golf courses and a sports stadium.

London UK Office
T: +44 (0)20 7440 8282
F: +44 (0)20 7440 8292
E: admin@battlemccarthy.com
www.battlemccarthy.com

DESIGN INITIATIVES/ACTIONS UNDERTAKEN

Battle McCarthy developed landscape proposals for the wider landscape including the golf courses, improvements to the existing sewage treatment works and Inner Harbor, internal landscape for the hotels and the range of spaces within the roof landscape of DestiNY.

The site presented a number of challenges and opportunities including:

- Poor landscape character as a result of previous industrial development.
- Key position at southern tip of Onondaga Lake with extensive views along the lake.
- Poor views within the site owing to infrastructure and industry.
- Contamination issues related to the sewage treatment plant, oil tank depot and the lake.
- Air pollution relating to the roads and sewage treatment plant.
- No link with existing trail along Onondaga Creek and the lake edge.
- Vegetated lake edge and associated wetland habitat.

The landscape design provided the opportunity to:

- Create a unique character for the site and a distinct sense of place.
- Develop DestiNY as a landscape destination linked with the lake.
- Form a stronger relationship with water including the network of waterways and the lake.
- Extend and link with the existing network of hiking and biking trails.
- Link the DestiNY spaces to a Syracuse-wide open space network to promote a logical cohesive city.
- Create a hierarchy of high quality, inter linked spaces and a legible network of routes.
- Use habitat creation as a key element within the landscape structure and character reflecting the native ecosystems of New York State.

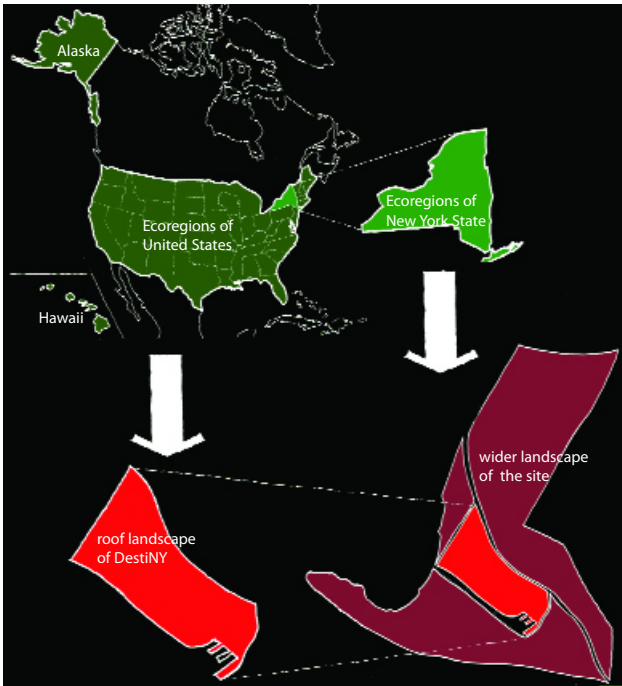

The roof landscape of DestiNY, a covered 100 acre park, provides a unique opportunity to create a controlled landscape experience linked to recreation and conservation. An extensive green roof 'summer park', on the exposed section of the roof, provides for informal recreation during the summer months. Beneath this is a sheltered 'winter park' that allows for comfortable use all year round.

The 'winter park' consists of a series of different landscape zones which are dependant on function, the use of adjoining buildings and the degree of daylight penetration.

Zones include:

- Convention Center
- Arrival/Stadium Concourse
- Park Connection Space
- Park Transition
- Hotel Foyer
- Hotel Garden
- Hilltown
- Park
- Canyon
- Aquapark
- Canal Edge

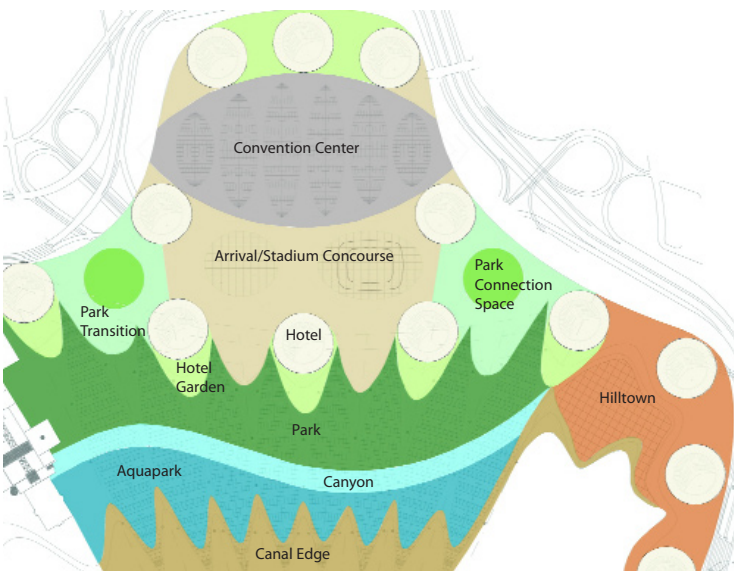

Roof Landscape Zoning Diagram

The existing water elements of the lake and Inner Harbor provide the opportunity to:

- Create a stronger relationship with water and the surrounding landscape by activating the edges of the existing water.
- Create a range of different water experiences.
- Create a formal linear park on the eastern edge of the Inner Harbor, linked to the roof landscape by a series of landscape terraces.
- Create a more informal edge on the western edge of the Inner Harbor related to the lake edge, golf course and sewage treatment works with a strong ecological function.

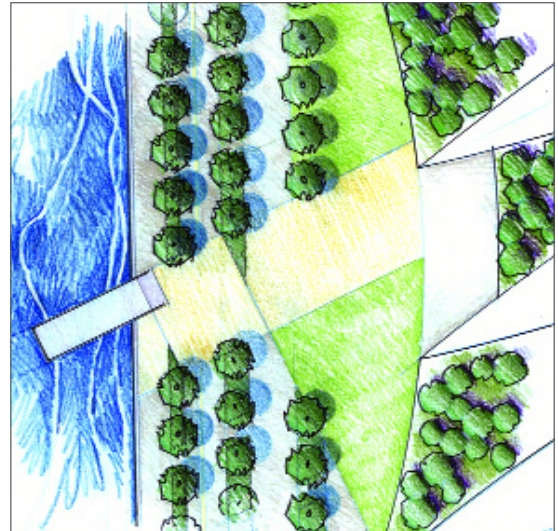

Plan of Inner Harbor Linear Park



Section of Inner Harbor Linear Park



Sketch of the Hilltown