

# BATTLE McCARTHY©

Consulting Engineers & Landscape Architects

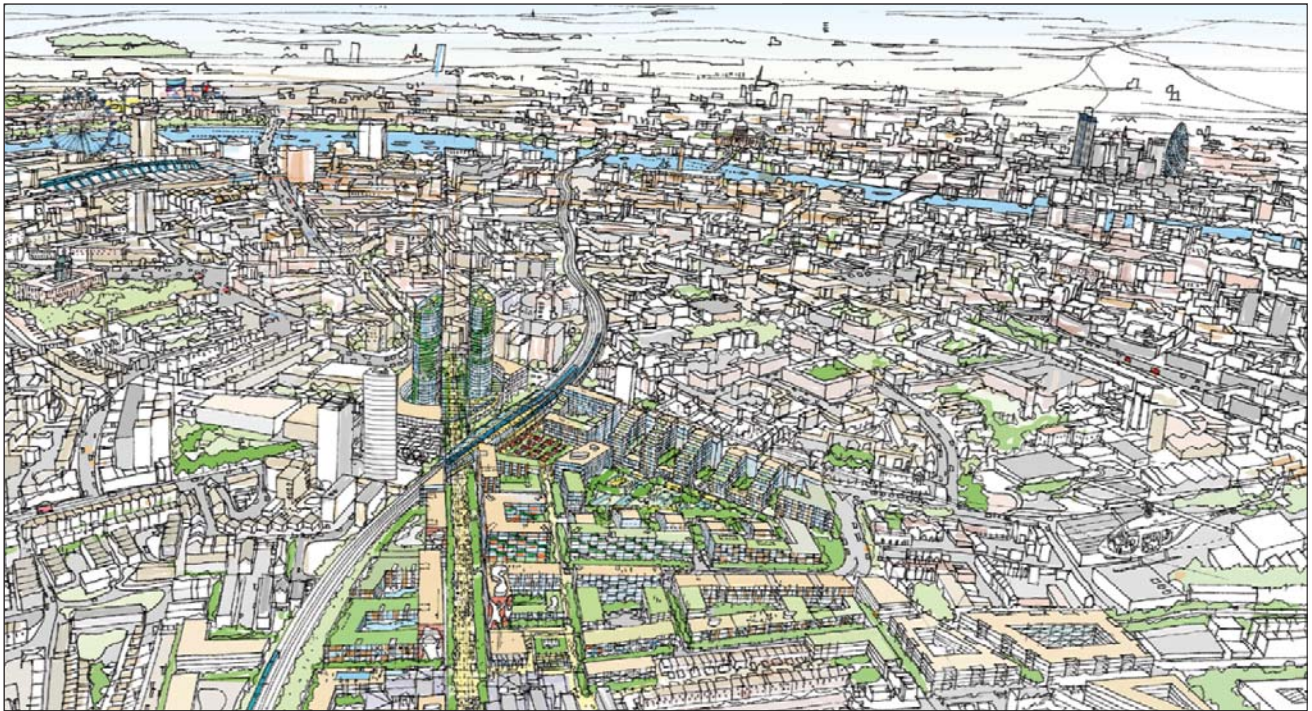

## PROJECT:

Elephant & Castle Development Framework

## CLIENT:

London Borough of Southwark

## ARCHITECTS:

Foster and Partners

## BM SERVICES:

Sustainable masterplanning & analysis

## VALUE:

Classified

## DESIGN BRIEF

To rejuvenate this large area of south London, currently dominated by roads and an undistinguished shopping centre.

The regeneration masterplan is the centrepiece of Southwark's strategy for revitalising the entire borough and is one of the largest masterplanning projects in Europe.

## DESIGN INITIATIVES/ACTIONS UNDERTAKEN

The most pressing aim of the masterplan is to banish traffic from the site and reclaim a large public square for the use and enjoyment of the local community. This square will form a centrepiece to surrounding shops, restaurants, housing, cultural centres and leisure facilities.

The existing station will also be rebuilt to serve as a major transport hub for the region with new links across London and the southeast.

A large shopping centre will be located under a large public park and office developments will cover the railway lines. The entire Heygate housing estate will be rebuilt as a mixture of social housing, affordable homes and private residences.

The 200 acres development will be the largest rejuvenation of its kind in London since the 1960s and will reclaim the Elephant and Castle as a social, economic and cultural focus for the south of London.

The site will eventually provide;

- Over 1 million sq.ft. shopping and leisure
- 3,500 new homes for sale
- Over 1,100 new social homes
- New public transport interchange
- 500,000 sq.ft. of offices
- One hotel
- 800,000 sq.ft. key worker accommodation
- New community facilities
- Three major parks (one of 15 acres)



London UK Office  
T: +44 (0)20 7440 8282  
F: +44 (0)20 7440 8292  
E: admin@battlemccarthy.com  
www.battlemccarthy.com

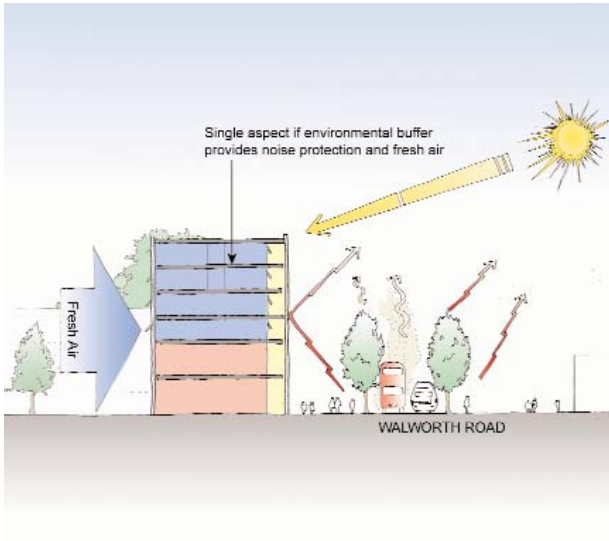

Environmental analysis of proposed buildings along the Walworth Road.

Battle McCarthy have been involved with the Elephant and Castle masterplan since initial concept design. Intensive environmental analysis has informed how existing spaces may be enhanced and how the failing Heygate Estate can be rebuilt to offer improved sustainable housing for the borough.

Solar and wind analysis was undertaken throughout the site to inform overall environmental strategies and to ascertain specific areas for extensive study. These include the open public areas where traffic fumes and wind channelling is an issue and also in the Heygate Estate where building massing has been proposed to promote daylighting to all residences and a comfortable wind environment for the central park.

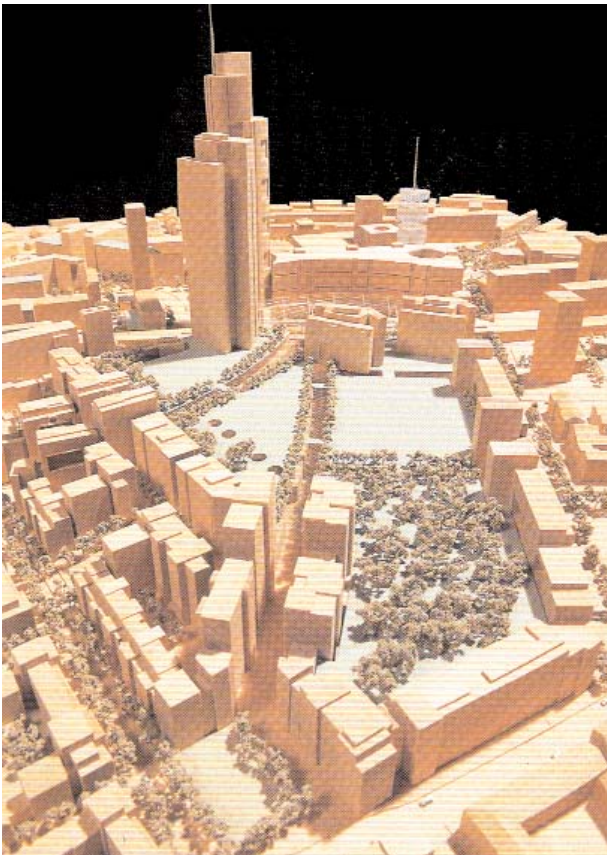

Architects model of the central residential area and public park

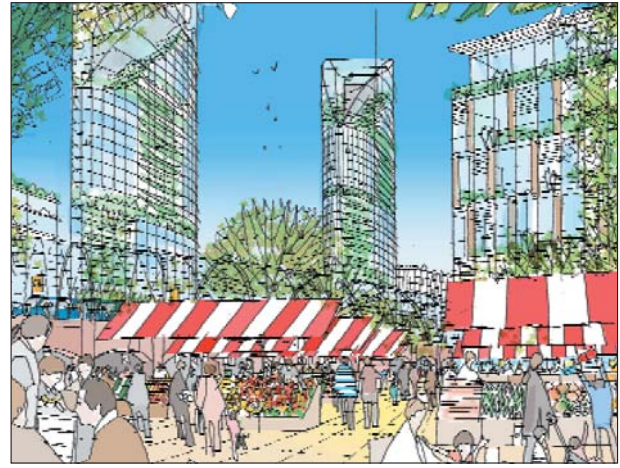

Artists images of various spaces within the masterplan