

BATTLE McCARTHY®

Consulting Engineers & Landscape Architects

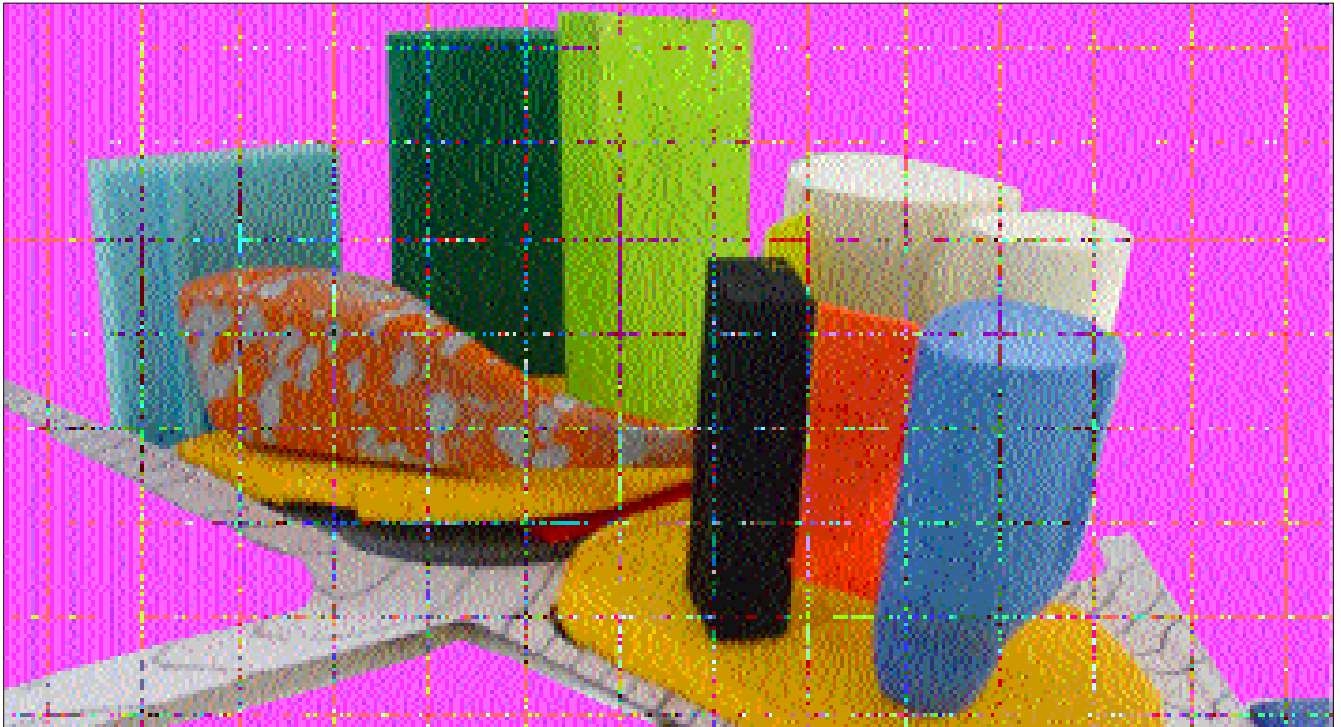

PROJECT:

City Park Gate, Masshouse Development

CLIENT:

Birmingham City Council

ARCHITECTS:

Alsop & Partners, T.R. Hamzah & Yeang

BM SERVICES:

Sustainable Masterplanning & Building Technology

VALUE:

£100million plus

DESIGN BRIEF

A competition submission for a major mixed-use development in Birmingham. The Masshouse development will join a number of other prestigious projects to form a large scale rejuvenation of Birmingham City centre.

Over 10 years and at a cost of £6billion an entire cultural quarter will be created to add to the newly completed Bullring and Selfridges store.

DESIGN INITIATIVES/ACTIONS UNDERTAKEN

To match Birmingham City Council's aspirations, the competition design focused on using innovative and inspirational ideas to create an iconic cultural and educational hub for the city.

The City Park Gateway will form a major phase of the overall development and will create office, residential, student housing, retail and leisure space over 2.3 hectares of formerly poorly used inner city land.

The Gateway will also form a vital link between the city's other major regeneration projects.

After shortlisting the competition was awarded to Ted Cullinan to develop the scheme within the overall mixed use development outlined by Richard Rogers Partnership prior to their design of the Bullring and Selfridges store.

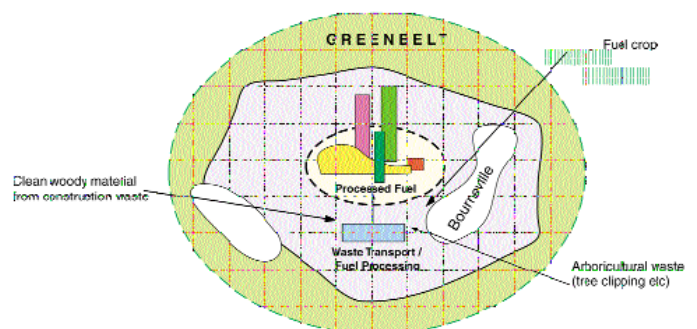

Fuel and energy strategy for the Gateway development

London UK Office
T: +44 (0)20 7440 8282
F: +44 (0)20 7440 8292
E: admin@battlemccarthy.com
www.battlemccarthy.com

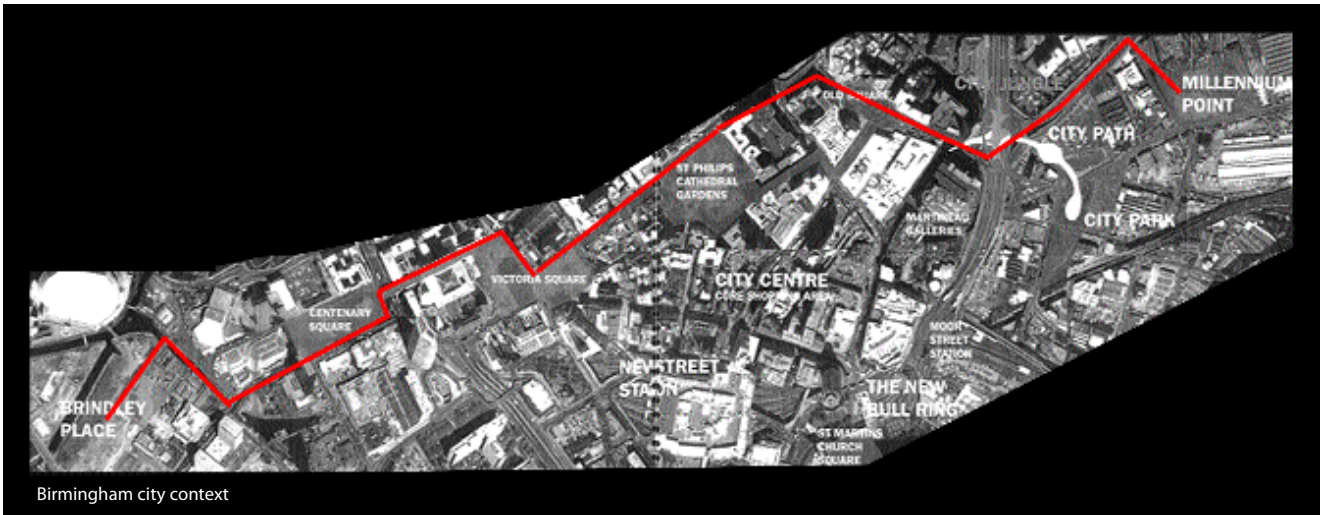

Birmingham city context

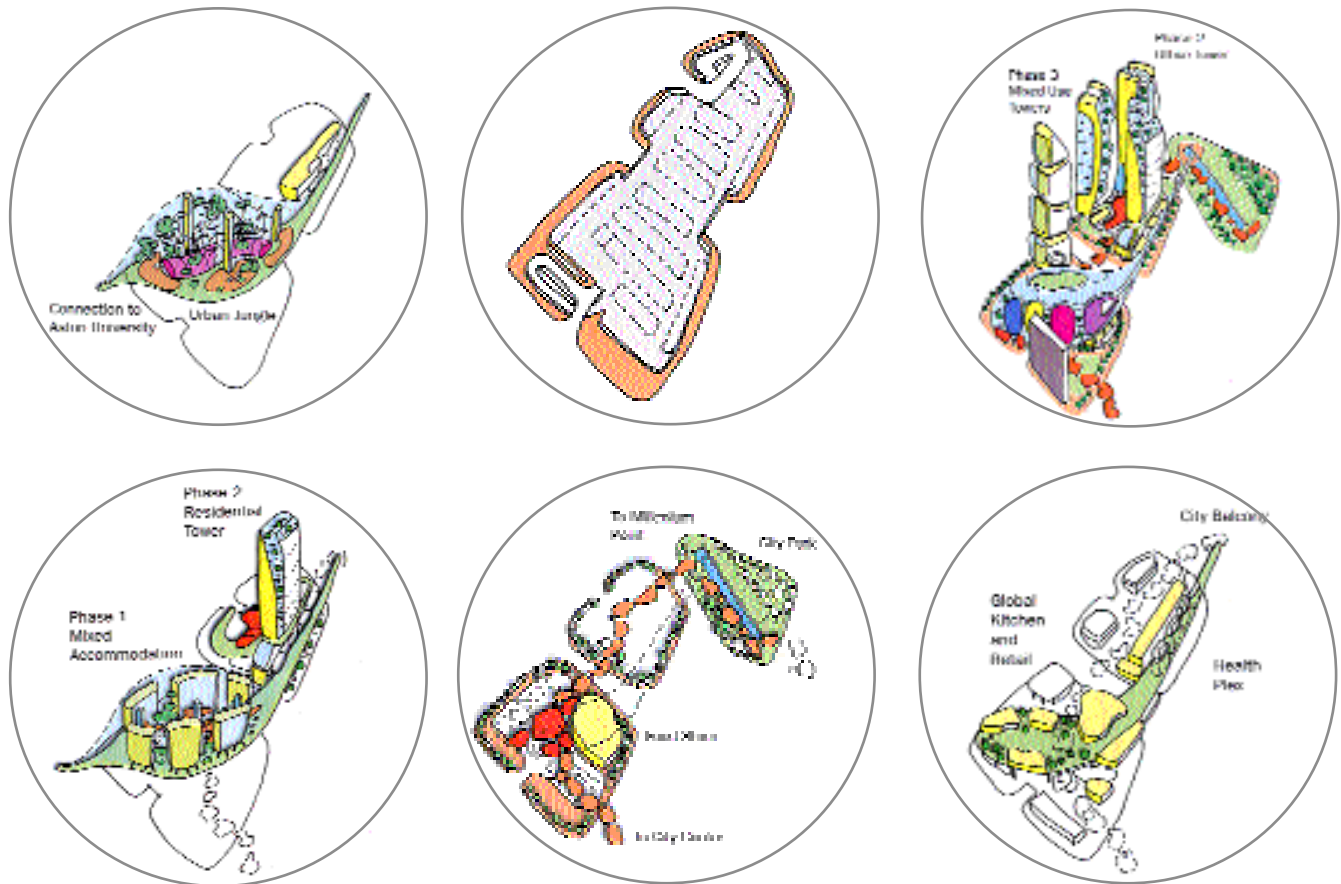

Design development

Imaginative use of new materials and construction techniques

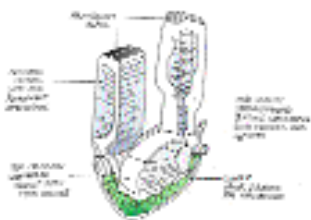

Maximise use of on-site renewable energy sources

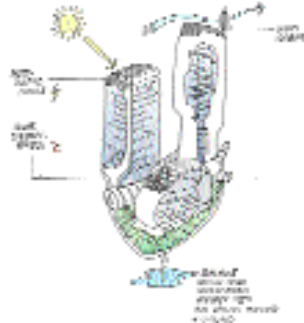

Balanced environment

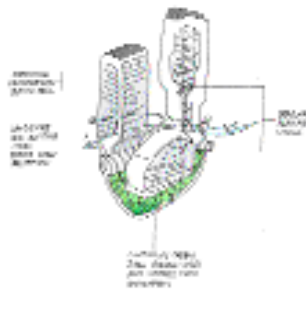

Maximise ecological benefit

