



PROJECT:

Prospect Place, Cardiff

CLIENT:

Bellway Homes

ARCHITECTS:

RMA Architects

BM SERVICES:

Landscape Architecture

VALUE:

£56million (approx)

DESIGN BRIEF

To develop the landscape design for a new residential development in Cardiff Bay. The landscape had to respond to the exposed microclimate, the reclaimed nature of the site, the contemporary nature of the architecture and the prestigious location within the Bay.

DESIGN INITIATIVES/ACTIONS UNDERTAKEN

The key landscape objectives for the development were:

- Create a high quality landscape setting for the buildings which reflects the contemporary landscape design approach adopted by other developments in the Bay.
- Recognise the site's prominent location within the Bay by framing views and providing shelter along pedestrian routes using planting.
- Use durable and robust materials that complement the architecture and create a high quality environment.
- Create a structured landscape that responds to the geometry of the buildings and has a strong graphic quality when viewed from the upper floors of the buildings.
- Express the man-made/reclaimed/controlled nature of the site in the structured approach to planting and combination with hard materials.
- Adopt a shared surface approach to roads on the site giving priority to pedestrians and cyclists through traffic calming measures and landscape elements extending across the road e.g. raised tables and textured paving bands.



Landscape Masterplan

The landscape is divided into three 'outdoor rooms' - a courtyard, a garden and a park. These 'rooms' provide a range of amenity spaces that relate directly to the surrounding buildings. Landscape elements including structured planting, landforms and works of art, emphasise the visual and physical links to the bay while creating a distinct identity for each of the three spaces.

A series of axes activate the spaces and act as visual and movement corridors. These axes respond to the geometry of the buildings, aligning with entrances and key architectural features, providing a strong spatial structure to the landscape.

An active bay edge is created including a pedestrian and cycle route, opportunities for seating and planting and bayside square. Sections of the promenade will be cantilevered to enhance the bay edge experience.

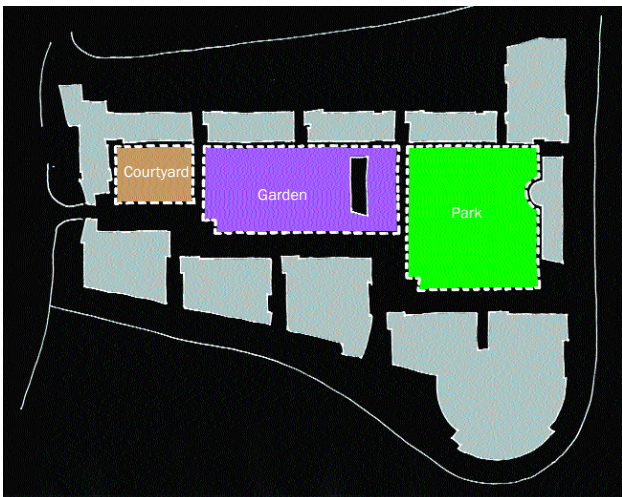

Landscape Structure



Marketing Suite landscape elements